

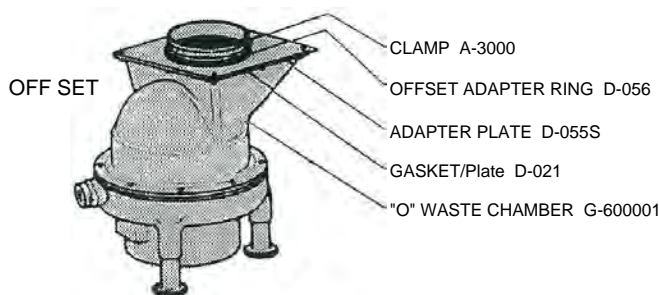

Discontinued Manufacturing as of 9/1/09

Limited Replacement Parts Available - Please contact Factory

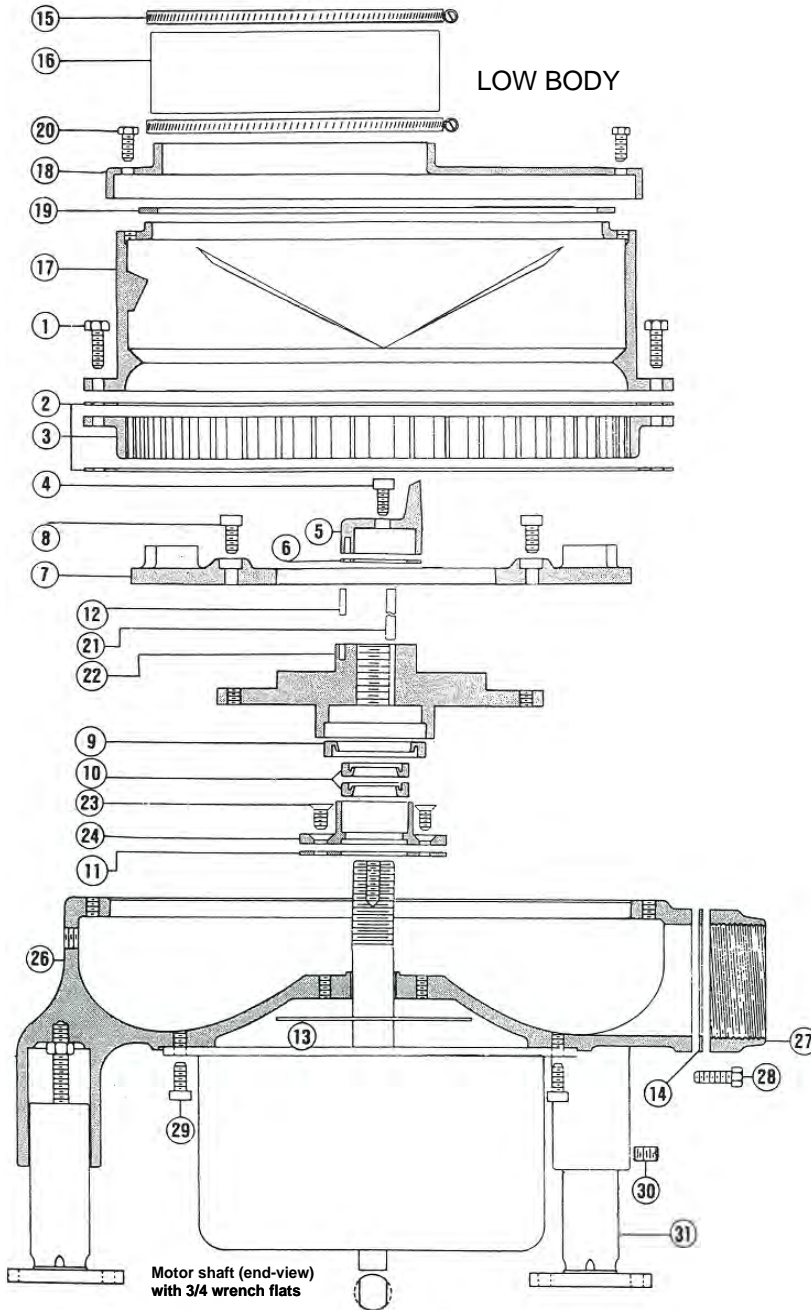

Item No.	Part No.
Numbers in parenthesis are total required quantities	
1 SCREWS/Waste Chamber (8)	A-4100
2 GASKET/Sizing Ring (2)	D-020
3 SIZING RING	D-006
4 SCREW/Center Breaker	A-4200
5 CENTER BREAKER	A-1288
6 GASKET/Center Breaker	A-1022
7 IMPACT RING/Rotor	MD68113B
8 SCREWS/Impact Ring	MD-13C
9 LIP SEAL/Impact Hub	D-1009
10 LIP SEALS/Motor Shaft (2)	A-1011
11 GASKET/Seal Housing	A-019
12 ROLL PIN	A-4201
13 SLINGER/Motor Shaft	A-016
14 GASKET/Discharge Flange	A-138
15 CLAMPS/Sleeve (2)	A-3000
16 SLEEVE - Connector	G-554
17 WASTE CHAMBER - L.B.	A-563
18 COVER/Waste Chamber	B-564
19 GASKET/Chamber Cover	A-560
20 SCREWS/Cover (4)	A-2100
21 KEY	A-1185
22 IMPACT HUB/Rotor Turntable	MD-13ANS
23 SCREWS/Seal Housing (4)	A-4202
24 SEAL HOUSING	D-1008
26 BOWL	G600000
27 DISCHARGE FLANGE	A-134
28 SCREWS/Discharge Flange (2)	A-2221
29 SCREWS/Motor (4)	A-2213
30 SET-SCREWS/Legs (3)	A-4121
31 LEG (3)	A-099
MOTOR OPTIONS	
- 5 HP / 3 PH	02-ABC-053
- 7.5 HP / 3 PH	02-ABC-723
- 10 HP / 3 PH	02-ABC-103
LOWER MOTOR BEARING	M-6206
UPPER MOTOR BEARING	M-6207
SEAL AND GASKET KIT	A-SGK-NS
- INCLUDES ITEMS	
2, 6, 9, 10, 11, 14, GREASE	
COMPLETE RENEWAL KIT	A-CRK-NS
- INCLUDES ITEMS	
1, 2, 3, 4, 5, 6, 7, 8, 9, 10, 11,	
12, 13, 14, GREASE	

SERIES "A" PROCEDURE FOR COMPLETE PARTS REPLACEMENT

DISASSEMBLY		REASSEMBLY	
REMOVE PARTS IN THE FOLLOWING ORDER		REASSEMBLE DISPOSER COMPONENTS IN FOLLOWING ORDER	
STEP	ITEM	STEP	ITEM
A CLAMPS/Sleeve (two). Only lower clamp may require removal	15	NOTE: If servicing did not proceed beyond Step F in Disassembly, proceed directly to Step K and continue reassembly. If disassembly proceeded beyond Step F, at this point reassemble Impact Hub and Impact Ring using Screws/Impact Ring to securely tighten the Impact Ring to Impact Hub and proceed with the following steps.	
B SCREWS/Waste Chamber (eight).	1	A GASKET/Seal Housing. Thoroughly clean surface for the correct seating of Gasket.	11
C WASTE CHAMBER. Mark Chamber (17) and Bowl (26) for aligning for reassembly. Note: Cover (18) need not be removed.	17	B LIP-SEALS/Motor Shaft (two). Pack each seal cavity with waterproof grease. With open sides up, press in greased housing counterbore	10
D SIZING RING. Pry up flange evenly to avoid cocking.	3	C SEAL HOUSING. Press on shaft with rotating downward motion, positioning housing well home on gasket.	24
GASKETS/Sizing Ring (two). Remove both gaskets with Ring.	2	D SCREWS/Seal Housing (four). Allen flat head screws secure the Seal Housing.	23
NOTE: At this point, if only Sizing Ring (3) and Impact Ring (7) are to be replaced, proceed with only E & F below. If other servicing is necessary, skip Steps E & F and proceed directly to Step G.		E LIP SEAL. Position in Impact Hub counterbore with open side facing out. Fill Impact Hub cavity with waterproof grease.	9
E SCREWS/Impact Ring (four). Hold 3/4" flats on shaft extension beneath motor with wrench or vise-grip for removal.	8	F ROTOR TURNTABLE ASSEMBLY. Impact Ring, Impact Hub, and Screws/Impact Ring. Rotate clockwise on shaft until it bottoms out and then turn counterclockwise two keyways and stop.	7, 22, 8
F IMPACT RING/Pry evenly to remove from Impact Hub	7	G KEY/Shaft. Inserted in keyway.	21
G SCREW/Center Breaker. Hold shaft extension.	4	H GASKET/Center Breaker.	6
H CENTER BREAKER. Winged Casting with ROLL PIN	5, 12	I CENTER BREAKER. Winged casting with Roll Pin (12). Make certain that pin enters locating hole.	5, 12
I GASKET/Center Breaker	6	J SCREW/Center Breaker. Hold shaft extension and replace screw. Skip to L.	4
J KEY/Shaft. Extra length to permit gripping	21	K IMPACT RING/Hold shaft extension and securely tighten on Impact Hub with Screws/Impact Ring.	7, 8
K ROTOR TURNTABLE ASSEMBLY. Impact Ring, Impact Hub, and Screws/Impact Ring. Grip shaft extension and turn Rotor counterclockwise.	7, 22, 8	L SIZING RING & GASKETS (two). With lower gasket placed on Bowl (26). Insert Ring, using uniform pressure. Place upper gasket on flange of Sizing Ring.	3, 2
L LIP SEAL. Remove for counterbore of Impact Hub (22).	9	M WASTE CHAMBER. Align marks and place on Sizing Ring Gasket.	17
M SCREWS/Seal Housing (four).	23	N SCREWS/Waste Chamber (eight). Tighten alternately.	1
N SEAL HOUSING. Remove with rotating, upward movement.	24	O CLAMPS/Sleeve (two). Tighten, with sleeve in position.	15
O LIP SEALS/Motor Shaft (two). Remove from counterbore	10		
P GASKET/Seal Housing.	11		
At this disassembly-point, clean, polish, and inspect shaft in seal area.			
To service motor, remove 4 Screws (29). Mark junction box location to facilitate repositioning .			
Install new replacement Slinger (13) on motor shaft. Before re-installing motor, thoroughly clean counterbore for motor-flange.			

Master Disposers

SOMAT COMPANY
 165 Independence Court, Lancaster, PA 17601
 717-397-5100 — FAX #717-299-4131
 800-237-6628 ext. 173 — www.masterdisposers.com

TW Food Equipment Group